

PIPE INLETS – NEW CONSTRUCTION

Pipe cast in situ

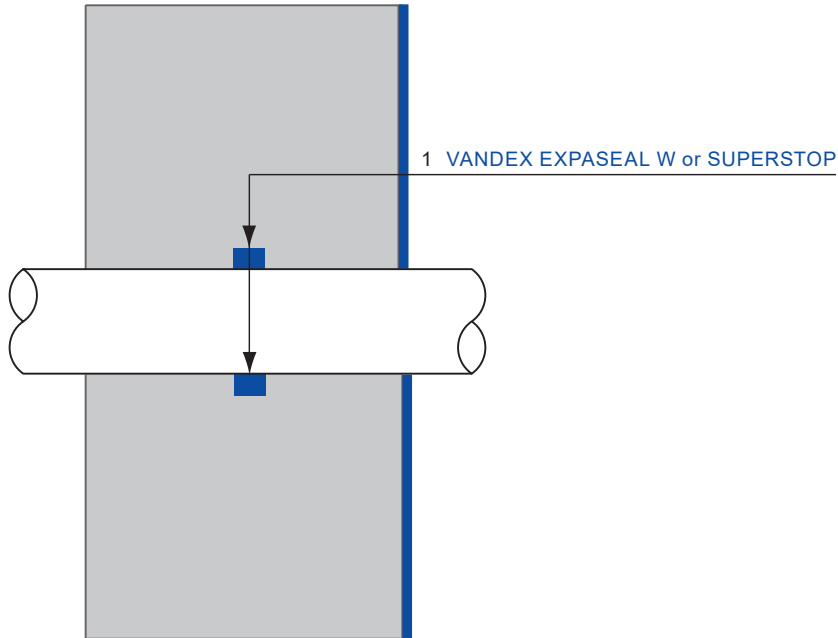

Pipe installed in recess after wall is poured

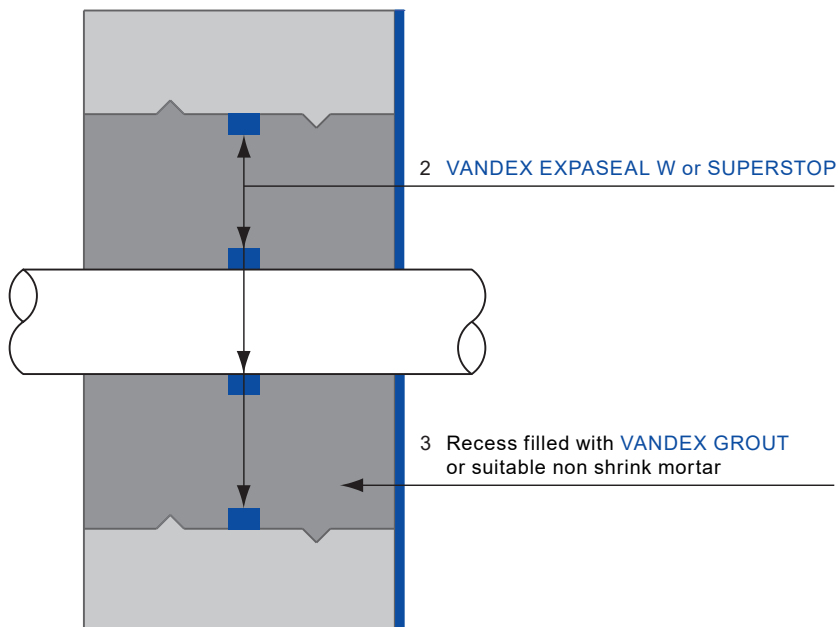

Application Instructions

- 1 Fix VANDEX EXPASEAL W or SUPERSTOP with VANDEX UNIFLEX around the pipe such that it is in the middle of the wall, before closing the formwork.
Ensure that the VANDEX EXPASEAL W or SUPERSTOP is in firm contact with surface of the pipe.
- 2 Fix VANDEX EXPASEAL W or SUPERSTOP with VANDEX UNIFLEX around the pipe such that it is centrally placed. Fix the VANDEX EXPASEAL W or SUPERSTOP with VANDEX UNIFLEX ADHESIVE.
- 3 Fill the recess preferably with VANDEX GROUT 20 depending on the size of cavity or with a non shrink mortar mix. The surface of the pipe must be clean and free of any foreign substances.

Remark:

- Substrate adhesion strength > 1.5 N/mm²

For further technical details and consumptions refer to technical data sheet or consult a technical Vandex representative.

The information contained herein is based on our long-term experience and the best of our knowledge. We can, however, make no guarantee since for a successful outcome, all circumstances in an individual case must be taken into consideration. Indications of quantities required are only averages which in certain cases might be greater.